

PLOT DATE: 08/18/2022 9:23:14 AM CAD USER: ECHIN

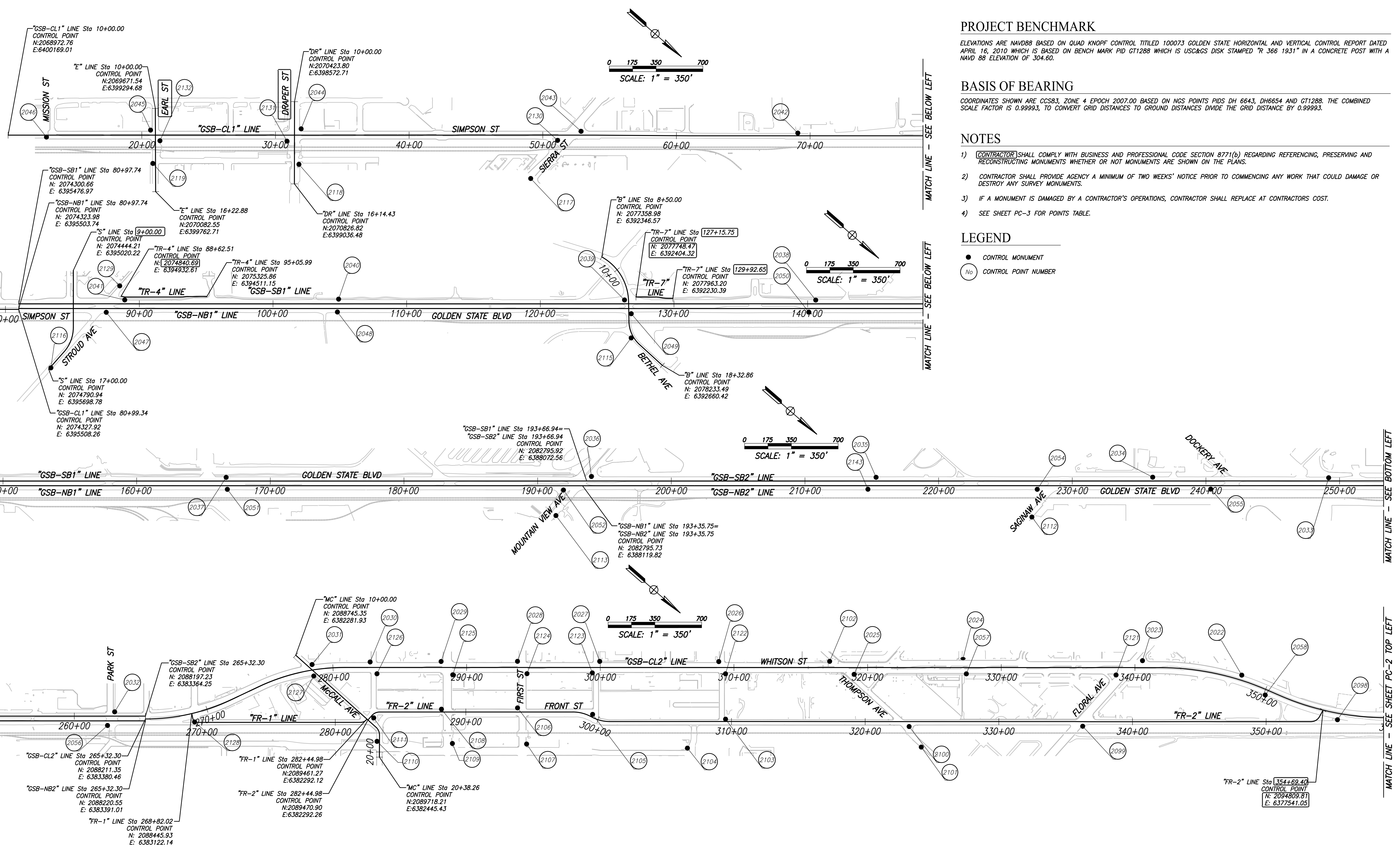

**PROJECT BENCHMARK**

ELEVATIONS ARE NAVD88 BASED ON QUAD KNOFF CONTROL TITLED 100073 GOLDEN STATE HORIZONTAL AND VERTICAL CONTROL REPORT DATED APRIL 16, 2010 WHICH IS BASED ON BENCH MARK PID GT1288 WHICH IS USC&GS DISK STAMPED "R 366 1931" IN A CONCRETE POST WITH A NAVD 88 ELEVATION OF 304.60.

**BASIS OF BEARING**

COORDINATES SHOWN ARE CCS83, ZONE 4 EPOCH 2007.00 BASED ON NGS POINTS PIDS DH 6643, DH6654 AND GT1288. THE COMBINED SCALE FACTOR IS 0.99993, TO CONVERT GRID DISTANCES TO GROUND DISTANCES DIVIDE THE GRID DISTANCE BY 0.99993.

**NOTES**

- 1) [CONTRACTOR] SHALL COMPLY WITH BUSINESS AND PROFESSIONAL CODE SECTION 8771(b) REGARDING REFERENCING, PRESERVING AND RECONSTRUCTING MONUMENTS WHETHER OR NOT MONUMENTS ARE SHOWN ON THE PLANS.
- 2) CONTRACTOR SHALL PROVIDE AGENCY A MINIMUM OF TWO WEEKS' NOTICE PRIOR TO COMMENCING ANY WORK THAT COULD DAMAGE OR DESTROY ANY SURVEY MONUMENTS.
- 3) IF A MONUMENT IS DAMAGED BY A CONTRACTOR'S OPERATIONS, CONTRACTOR SHALL REPLACE AT CONTRACTOR'S COST.
- 4) SEE SHEET PC-3 FOR POINTS TABLE.

**LEGEND**

- CONTROL MONUMENT
- CONTROL POINT NUMBER

DESIGNED: CYNTHIA HORNER	DATE	RECORD DRAWING	DATE
DRAWN: ERIK CHIN		RESIDENT ENGINEER	
CHECKED: MATT STRINGER			

FOR RIGHT OF WAY DATA AND ACCURATE ACCESS DETERMINATION, SEE DOCUMENTS IN THE DEPARTMENT OF PUBLIC WORKS AND PLANNING.



SUPERVISING ENGINEER \_\_\_\_\_ DATE \_\_\_\_\_

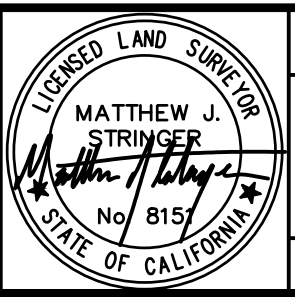

PROJECT - PHASE 1  
 GOLDEN STATE CORRIDOR - ECONOMIC DEVELOPMENT AND INFRASTRUCTURE IMPROVEMENTS  
 KINGSBURG REGION



DEPARTMENT OF PUBLIC WORKS AND PLANNING  
 PROJECT CONTROL  
 DRAWING NO. PC-1 SHEET NO. 9A TOTAL 108

GAD USER: ECHIN

PLOT DATE: 09/16/2023 9:23:22 AM

PATH: \\freese-c06-pk-16105-gsb-final-design\cadd\sheet\Region 1\GSB\_R1\_PC-PC2\_P1.dwg

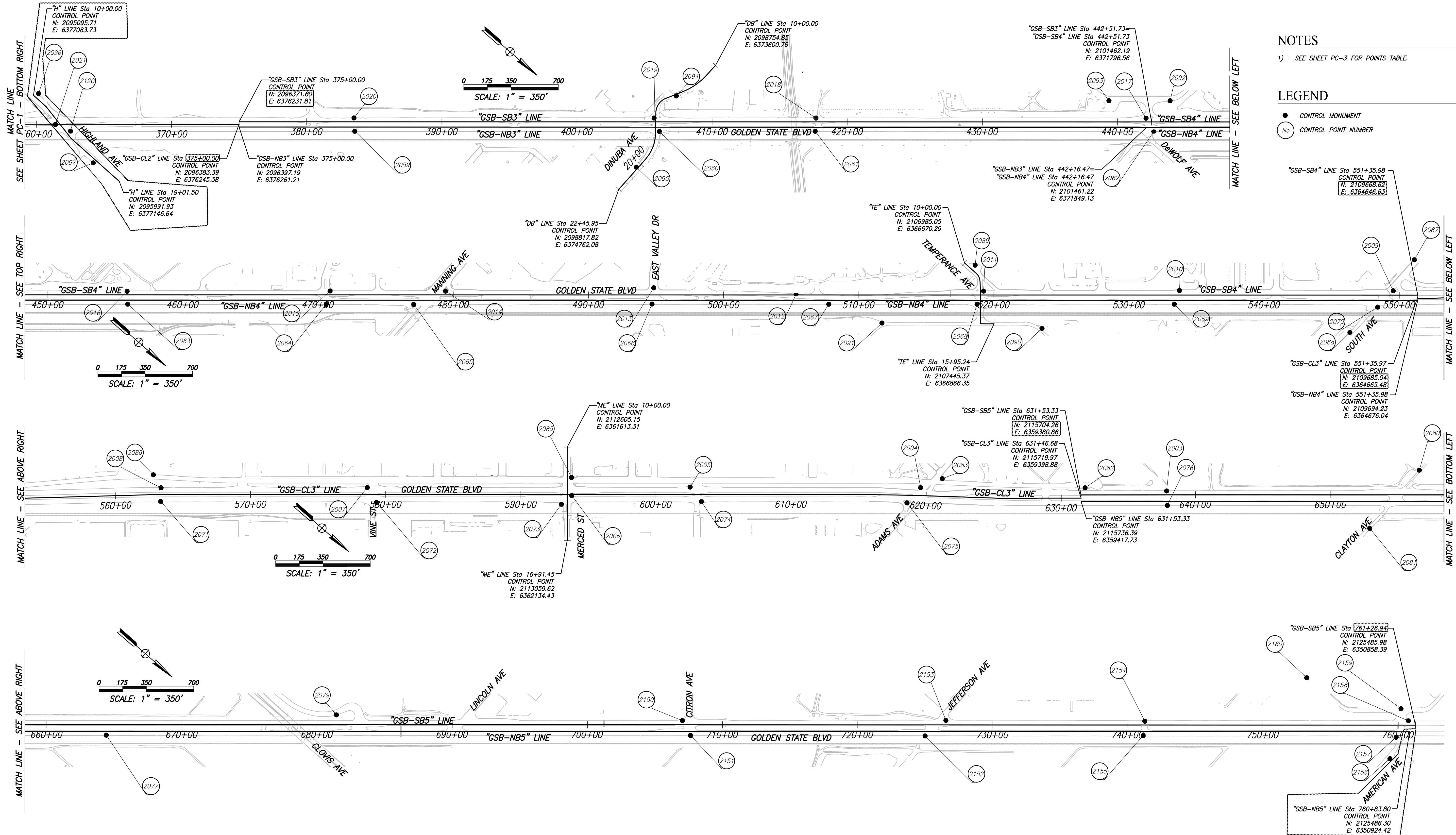

**NOTES**

1) SEE SHEET PC-3 FOR POINTS TABLE.

**LEGEND**

- CONTROL MONUMENT
- CONTROL POINT NUMBER

- "GSB-SB4" LINE Sta 551+35.98  
CONTROL POINT  
N: 2109688.62  
E: 6364646.63
- "GSB-NB4" LINE Sta 551+35.98  
CONTROL POINT  
N: 2109685.04  
E: 6364665.48
- "GSB-CL3" LINE Sta 551+35.97  
CONTROL POINT  
N: 2109685.04  
E: 6364665.48
- "GSB-NB4" LINE Sta 551+35.98  
CONTROL POINT  
N: 2109694.23  
E: 6364676.04

- "GSB-SB5" LINE Sta 761+26.94  
CONTROL POINT  
N: 2125485.98  
E: 6350858.39
- "GSB-NB5" LINE Sta 760+83.80  
CONTROL POINT  
N: 2125486.30  
E: 6350924.42

DESIGNED: CYNTHIA HORNER	DATE	RECORD DRAWING	
DRAWN: ERIK CHIN		RESIDENT ENGINEER	DATE
CHECKED: MATT STRINGER			

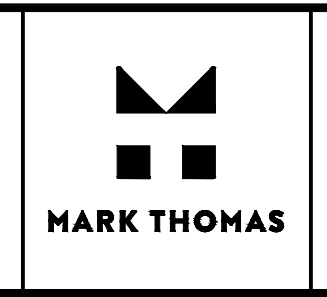

\_\_\_\_\_  
SUPERVISING ENGINEER

\_\_\_\_\_  
DATE



PROJECT - PHASE 1

GOLDEN STATE CORRIDOR - ECONOMIC DEVELOPMENT AND INFRASTRUCTURE IMPROVEMENTS

KINGSBURG REGION



DEPARTMENT OF PUBLIC WORKS AND PLANNING

PROJECT CONTROL

DRAWING NO. PC-2 SHEET NO. 10A TOTAL 108

FOR RIGHT OF WAY DATA AND ACCURATE ACCESS DETERMINATION, SEE DOCUMENTS IN THE DEPARTMENT OF PUBLIC WORKS AND PLANNING.

Point Table			
Point #	Northing	Easting	Raw Description
2003	2116161.70	6358943.38	NAIL & SHINER
2004	2114774.02	6360120.81	CHISLED X
2005	2113485.27	6361237.84	NAIL & SHINER
2006	2112865.89	6361860.67	NAIL & SHINER
2007	2111686.35	6362810.58	NAIL & SHINER
2008	2110537.37	6363814.36	NAIL & SHINER
2009	2109510.78	6364741.51	NAIL & SHINER
2010	2108317.28	6365779.40	MAG NAIL
2011	2107227.88	6366734.71	MAG NAIL
2012	2106197.31	6367664.45	MAG NAIL
2013	2105371.75	6368320.30	MAG NAIL
2014	2104226.89	6369350.79	MAG NAIL
2015	2103581.78	6369911.32	MAG NAIL
2016	2102451.09	6370899.66	MAG NAIL
2017	2101412.99	6371802.82	MAG NAIL
2018	2099571.23	6373406.64	MAG NAIL
2019	2098667.71	6374193.41	MAG NAIL
2020	2096993.39	6375651.96	MAG NAIL
2021	2095360.15	6377139.27	MAG NAIL
2022	2094179.37	6377743.84	MAG NAIL
2023	2093548.19	6378150.19	SCRIBED X
2024	2092525.80	6379020.92	SCRIBED X
2025	2091988.94	6379644.79	SCRIBED X
2026	2091162.98	6380238.39	SCRIBED X
2027	2090490.37	6380822.58	SCRIBED X
2028	2090026.34	6381226.43	SCRIBED X
2029	2089596.29	6381602.60	SCRIBED X
2030	2089198.20	6381954.31	SCRIBED X
2031	2088883.40	6382254.29	SCRIBED X
2032	2088002.46	6383491.48	SCRIBED X
2033	2086965.15	6384406.95	MAG NAIL
2034	2085969.88	6385268.67	MAG NAIL
2035	2084410.11	6386629.11	MAG NAIL
2036	2082800.54	6388023.81	CHISLED X
2037	2080744.79	6389824.36	NAIL & SHINER
2038	2078777.36	6391538.12	NAIL & SHINER

Point Table			
Point #	Northing	Easting	Raw Description
2039	2077698.33	6392477.29	NAIL & SHINER
2040	2076081.71	6393878.16	NAIL & SHINER
2041	2074879.34	6394934.09	NAIL & SHINER
2042	2073416.33	6396275.30	NAIL & SHINER
2043	2072185.68	6397330.94	CHISLED X
2044	2070594.48	6398693.21	CHISLED X
2045	2069751.36	6399440.44	CHISLED X
2046	2069198.36	6399991.57	NAIL & SHINER
2047	2074835.86	6395094.61	NAIL & SHINER
2048	2076138.24	6393956.67	NAIL & SHINER
2049	2077803.81	6392521.81	NAIL & SHINER
2050	2078797.89	6391639.88	MAG NAIL
2051	2080810.07	6389885.97	NAIL & SHINER
2052	2082709.32	6388237.48	CHISLED X
2054	2085378.08	6385904.57	NAIL & SHINER
2055	2086355.67	6385050.65	MAG NAIL
2056	2088029.27	6383603.22	MAG NAIL
2057	2092619.57	6379090.46	SCRIBED X
2058	2094409.15	6377740.46	MAG NAIL
2059	2097063.08	6375722.29	MAG NAIL
2060	2098762.34	6374242.46	MAG NAIL
2061	2099631.06	6373483.82	MAG NAIL
2062	2101521.21	6371838.91	MAG NAIL
2063	2102517.33	6370968.38	MAG NAIL
2064	2103624.84	6370004.54	MAG NAIL
2065	2104114.29	6369579.36	MAG NAIL
2066	2105441.02	6368418.91	MAG NAIL
2067	2106428.09	6367560.23	MAG NAIL
2068	2107254.84	6366839.71	NAIL & SHINER
2069	2108355.11	6365880.89	MAG NAIL
2070	2109503.82	6364908.28	NAIL & SHINER
2071	2110601.42	6363891.83	NAIL & SHINER
2072	2111810.55	6362847.57	NAIL & SHINER
2073	2112850.72	6361959.79	CHISLED X
2074	2113618.78	6361264.70	NAIL & SHINER
2075	2114771.57	6360272.17	CHISLED X

Point Table			
Point #	Northing	Easting	Raw Description
2076	2116236.20	6359020.57	NAIL & SHINER
2077	2118232.42	6357279.42	NAIL & SHINER
2079	2119417.63	6356047.49	NAIL & SHINER
2080	2117470.35	6357598.65	NAIL & SHINER
2081	2117477.21	6358164.63	NAIL & SHINER
2082	2115692.00	6359322.24	NAIL & SHINER
2083	2114850.75	6359965.61	CHISLED X
2085	2112776.83	6361761.51	NAIL & SHINER
2086	2110431.36	6363779.54	NAIL & SHINER
2087	2109478.42	6364465.95	NAIL & SHINER
2088	2109472.19	6365184.41	MAG NAIL
2089	2107054.72	6366631.47	MAG NAIL
2090	2107735.10	6366659.05	MAG NAIL
2091	2106816.12	6367407.01	NAIL & SHINER
2092	2101462.64	6371588.26	MAG NAIL
2093	2101121.25	6371885.50	MAG NAIL
2094	2098684.13	6373962.31	MAG NAIL
2095	2098808.06	6374553.41	MAG NAIL
2096	2095115.96	6377048.74	SCRIBED X
2097	2095757.87	6377170.16	MAG NAIL
2098	2094938.25	6377524.75	MAG NAIL
2099	2093533.15	6378813.90	SCRIBED X
2100	2092555.79	6379668.74	MAG NAIL
2101	2092725.19	6379724.91	MAG NAIL
2102	2091787.06	6379691.75	SCRIBED X
2103	2091484.15	6380529.63	SCRIBED X
2104	2091411.39	6380880.49	SCRIBED X
2105	2090710.69	6381156.13	MAG NAIL
2106	2090255.37	6381488.68	SCRIBED X
2107	2090484.12	6381647.80	SCRIBED X
2108	2089832.79	6381869.93	SCRIBED X
2109	2090062.76	6382009.47	SCRIBED X
2110	2089627.23	6382368.15	MAG NAIL
2111	2089493.39	6382252.01	SCRIBED X
2112	2085484.07	6386087.06	MAG NAIL
2113	2082792.24	6388418.50	NAIL & SHINER

Point Table			
Point #	Northing	Easting	Raw Description
2115	2077922.64	6392658.57	NAIL & SHINER
2116	2074796.68	6395679.74	NAIL & SHINER
2117	2072133.30	6397844.57	CHISLED X
2118	2070756.47	6398904.18	NAIL & SHINER
2119	2069928.05	6399617.05	NAIL & SHINER
2120	2095476.11	6377103.27	MAG NAIL
2121	2093469.54	6378361.00	SCRIBED X
2122	2091260.97	6380274.09	SCRIBED X
2123	2090505.21	6380923.85	SCRIBED X
2124	2090140.57	6381249.51	SCRIBED X
2125	2089727.51	6381620.50	SCRIBED X
2126	2089294.91	6381987.34	SCRIBED X
2127	2088949.47	6382310.38	SCRIBED X
2128	2088502.82	6383155.62	MAG NAIL
2129	2074782.16	6394879.36	NAIL & SHINER
2130	2072097.37	6397497.47	CHISLED X
2131	2070574.90	6398832.16	CHISLED X
2132	2069856.48	6399454.46	NAIL & SHINER
2143	2084422.76	6386736.42	NAIL & SHINER

Point Table				
Point #	Northing	Easting	Elevation	Raw Description
2150	2121374.97	6354397.67	305.05	MAG NAIL
2151	2121492.22	6354440.63	304.09	MAG NAIL
2152	2122803.11	6353303.14	306.25	MAG NAIL
2153	2122844.29	6353115.12	306.27	MAG NAIL
2154	2123957.67	6352152.51	304.29	MAG NAIL
2155	2124018.23	6352239.92	303.44	MAG NAIL
2156	2125507.00	6351169.94	301.83	MAG NAIL
2157	2125437.29	6351020.12	301.56	MAG NAIL
2158	2125426.00	6350869.16	303.17	MAG NAIL
2159	2125325.80	6350837.24	299.45	MAG NAIL
2160	2124650.18	6351123.06	302.82	MAG NAIL
2161	2125474.61	6350391.74	302.65	MAG NAIL
2162	2125987.98	6350383.60	302.12	MAG NAIL
2153	2126058.58	6350463.21	301.19	MAG NAIL

DESIGNED: CYNTHIA HORNER	DATE	RECORD DRAWING	
DRAWN: ERIK CHIN		RESIDENT ENGINEER	DATE
CHECKED: MATT STRINGER			
FOR RIGHT OF WAY DATA AND ACCURATE ACCESS DETERMINATION, SEE DOCUMENTS IN THE DEPARTMENT OF PUBLIC WORKS AND PLANNING.			

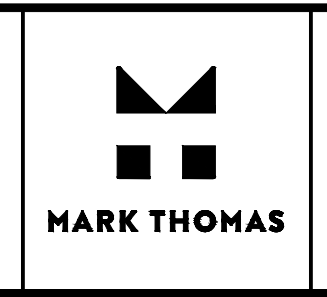

SUPERVISING ENGINEER	DATE
----------------------	------



PROJECT - PHASE 1
GOLDEN STATE CORRIDOR - ECONOMIC DEVELOPMENT AND INFRASTRUCTURE IMPROVEMENTS
KINGSBURG REGION



DEPARTMENT OF PUBLIC WORKS AND PLANNING
PROJECT CONTROL
DRAWING NO. PC-3
SHEET NO. 11A
TOTAL 108

**NOTES**

1. ALL STATION AND OFFSET CALLOUTS ON THIS SHEET ARE IN REFERENCE TO THE "GSB-CL1" LINE UNLESS OTHERWISE NOTED

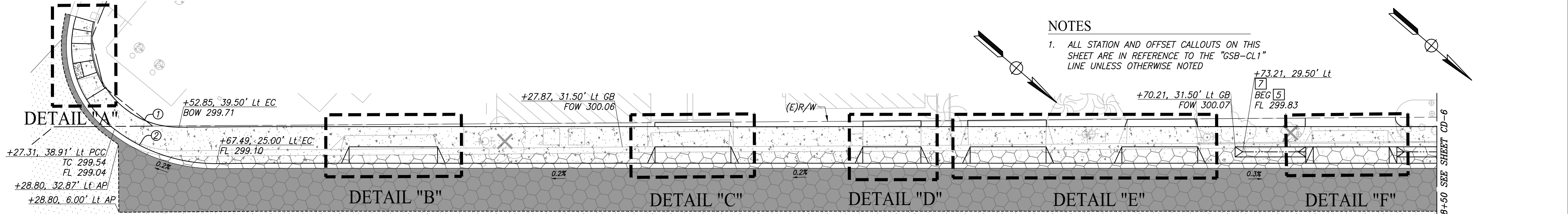

CURVE TABLE				
CURVE #	RADIUS	DELTA	TANGENT	LENGTH
1	34.00'	103°15'27"	42.94'	61.27'
2	65.00'	38°11'22"	22.50'	43.32'
3	40.00'	72°02'01"	42.94'	61.27'

**SIMPSON STREET**

SCALE: 1" = 40'

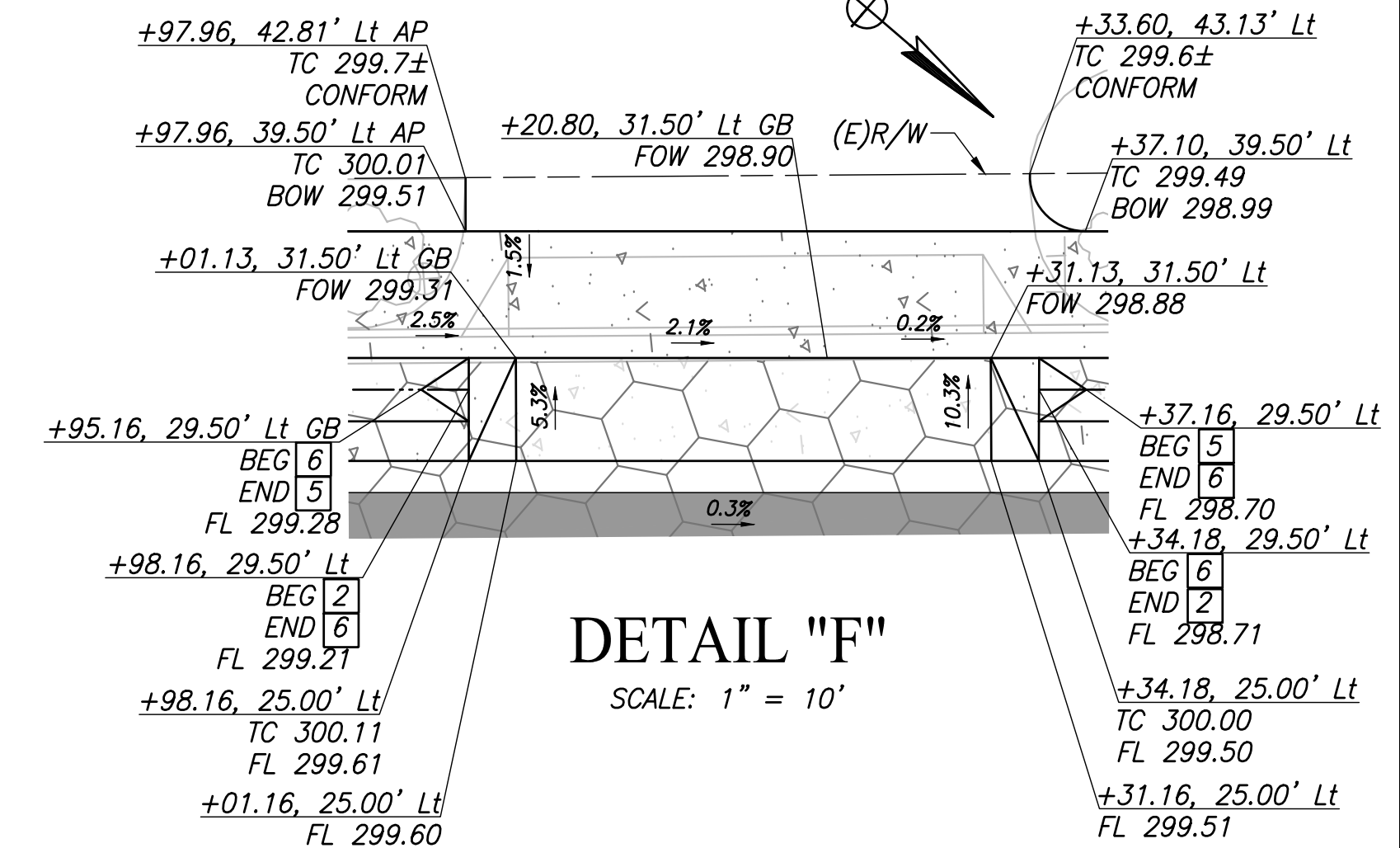
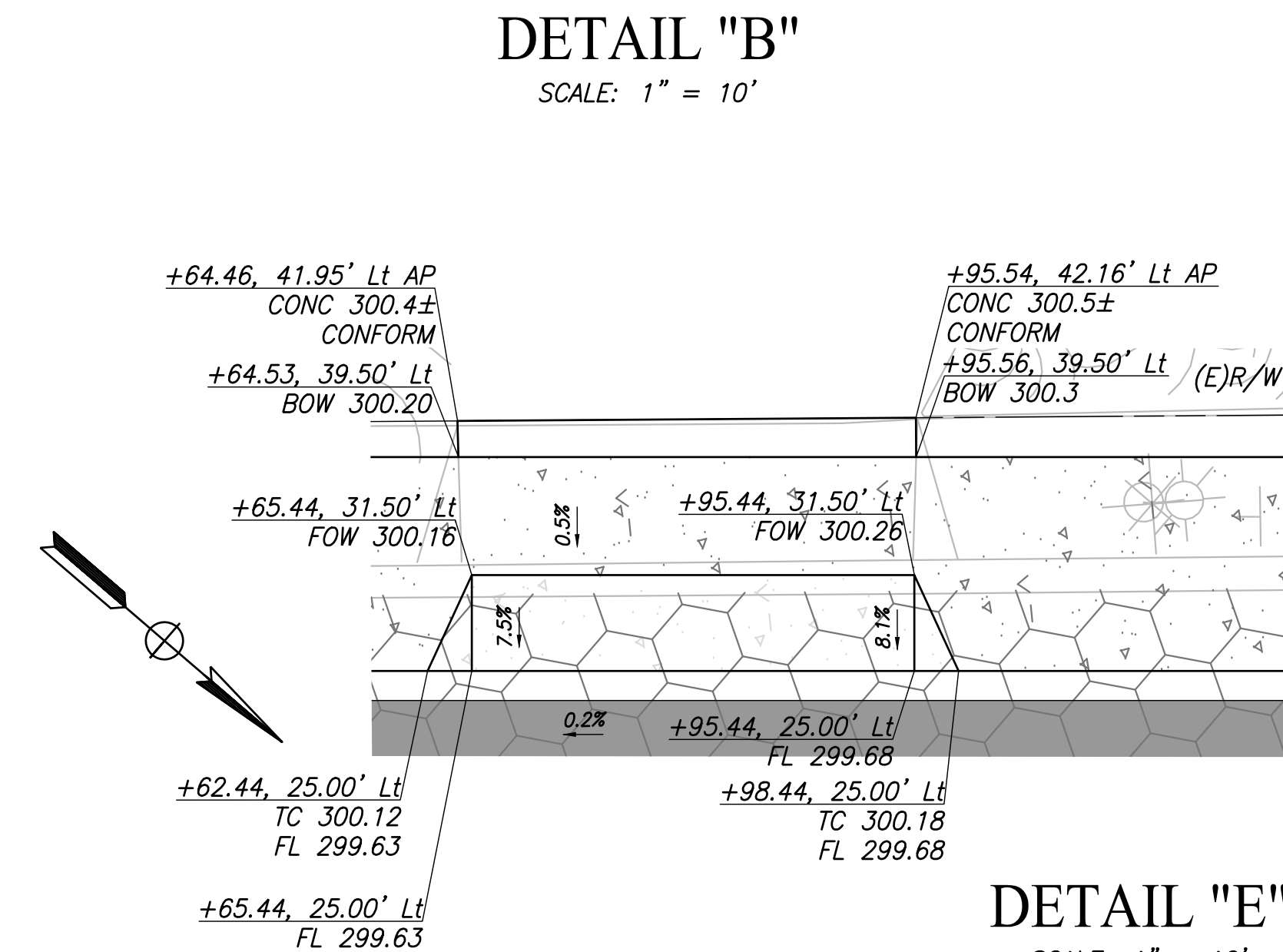
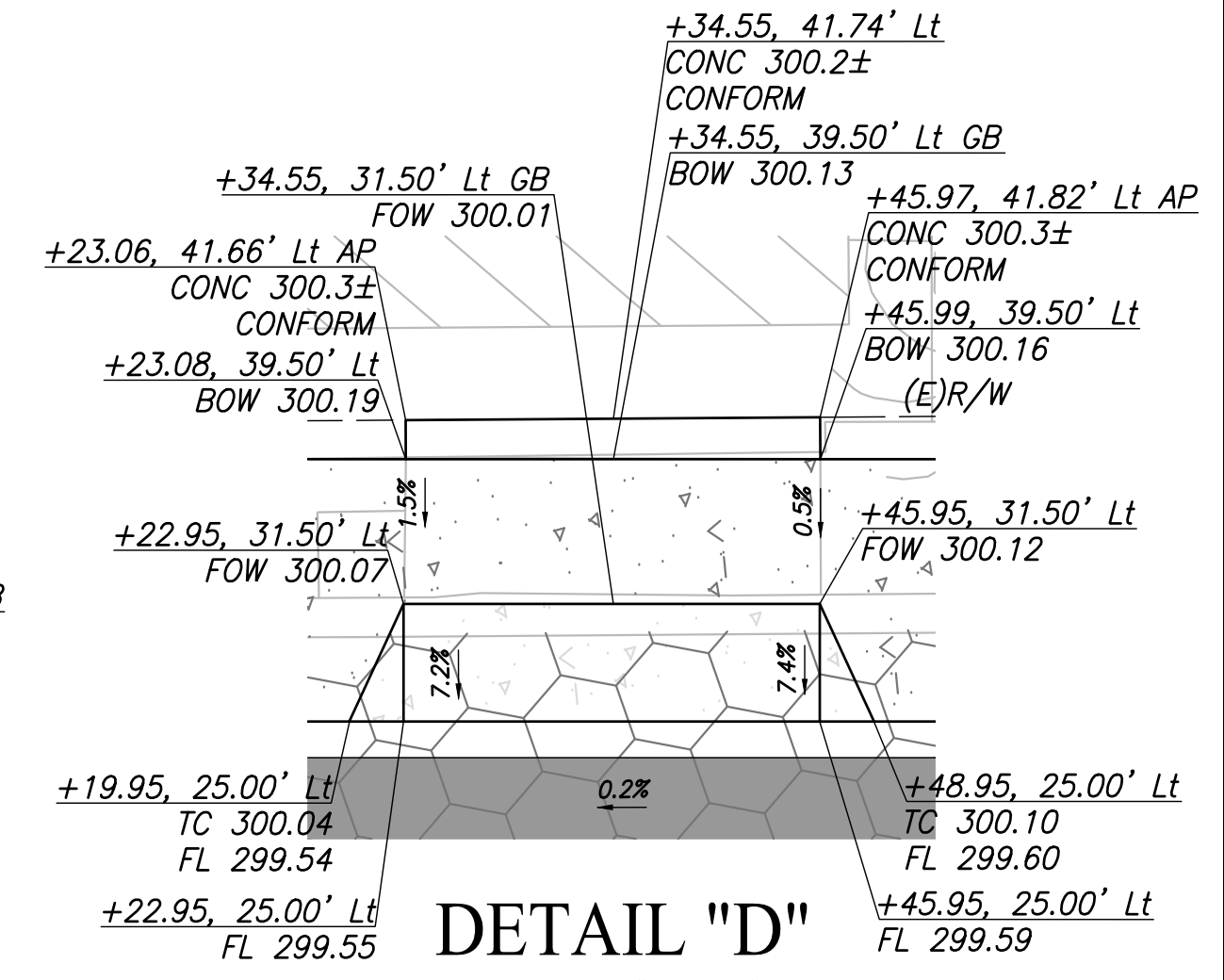
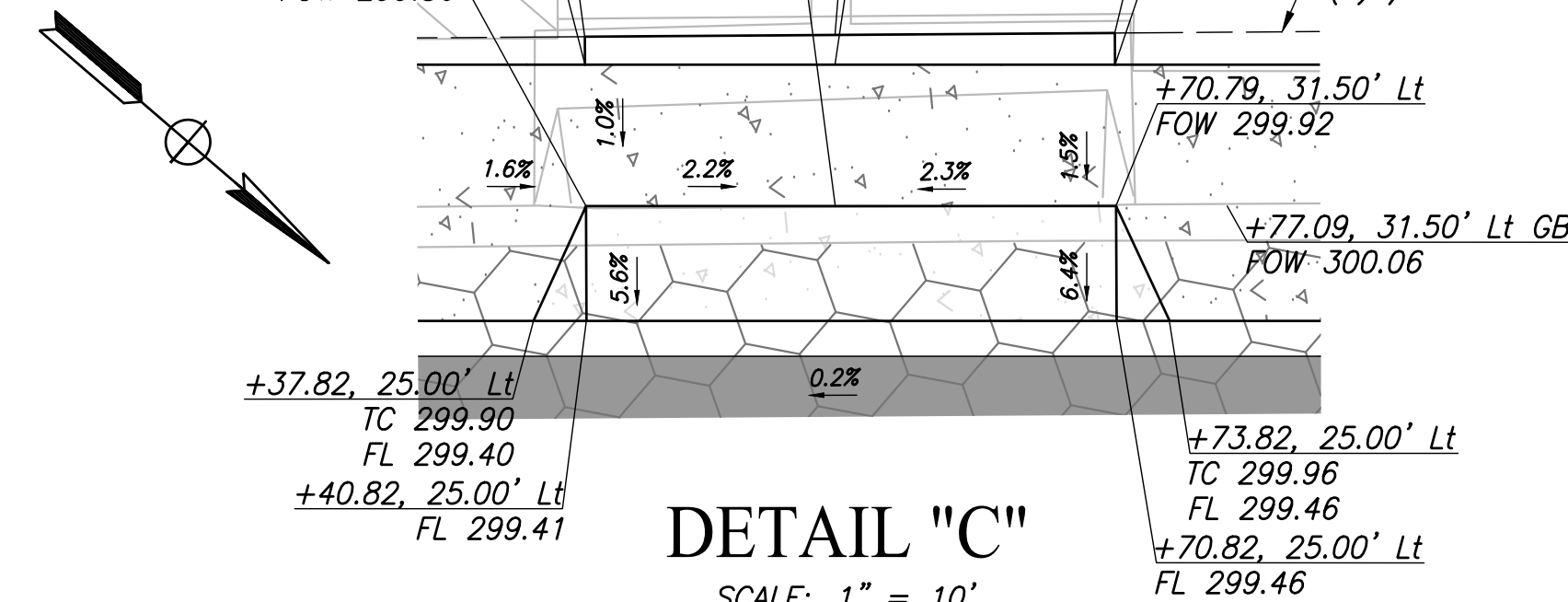
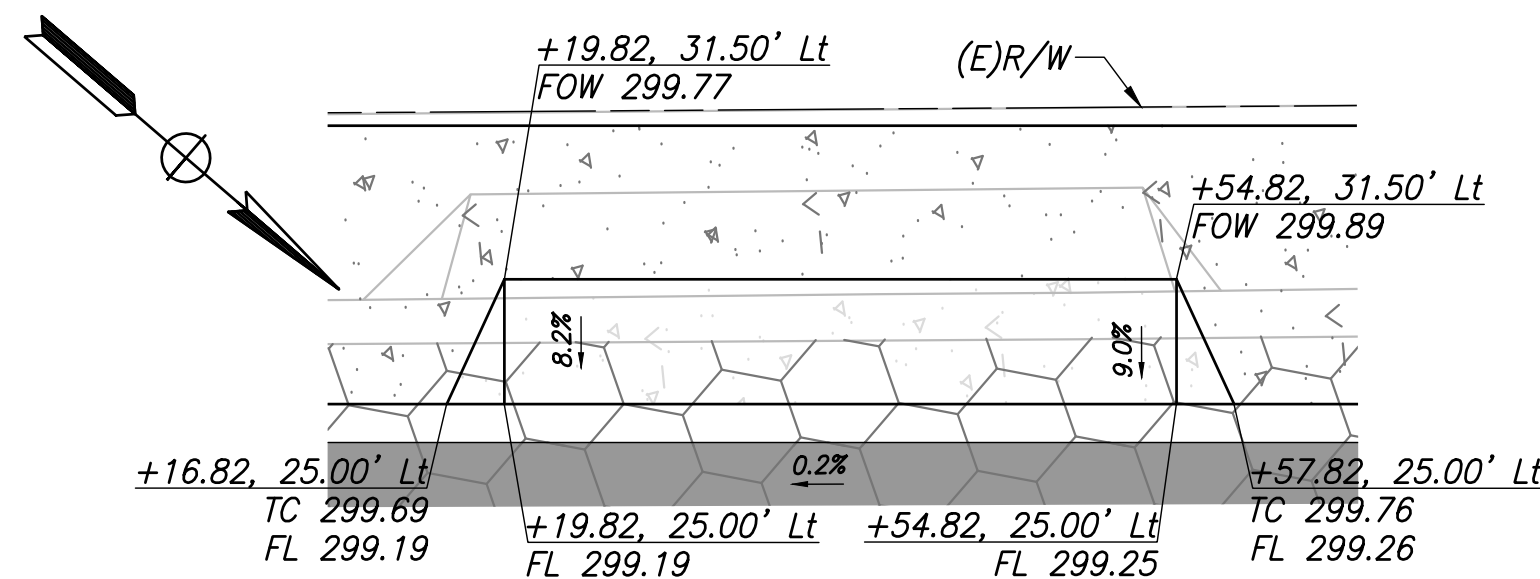
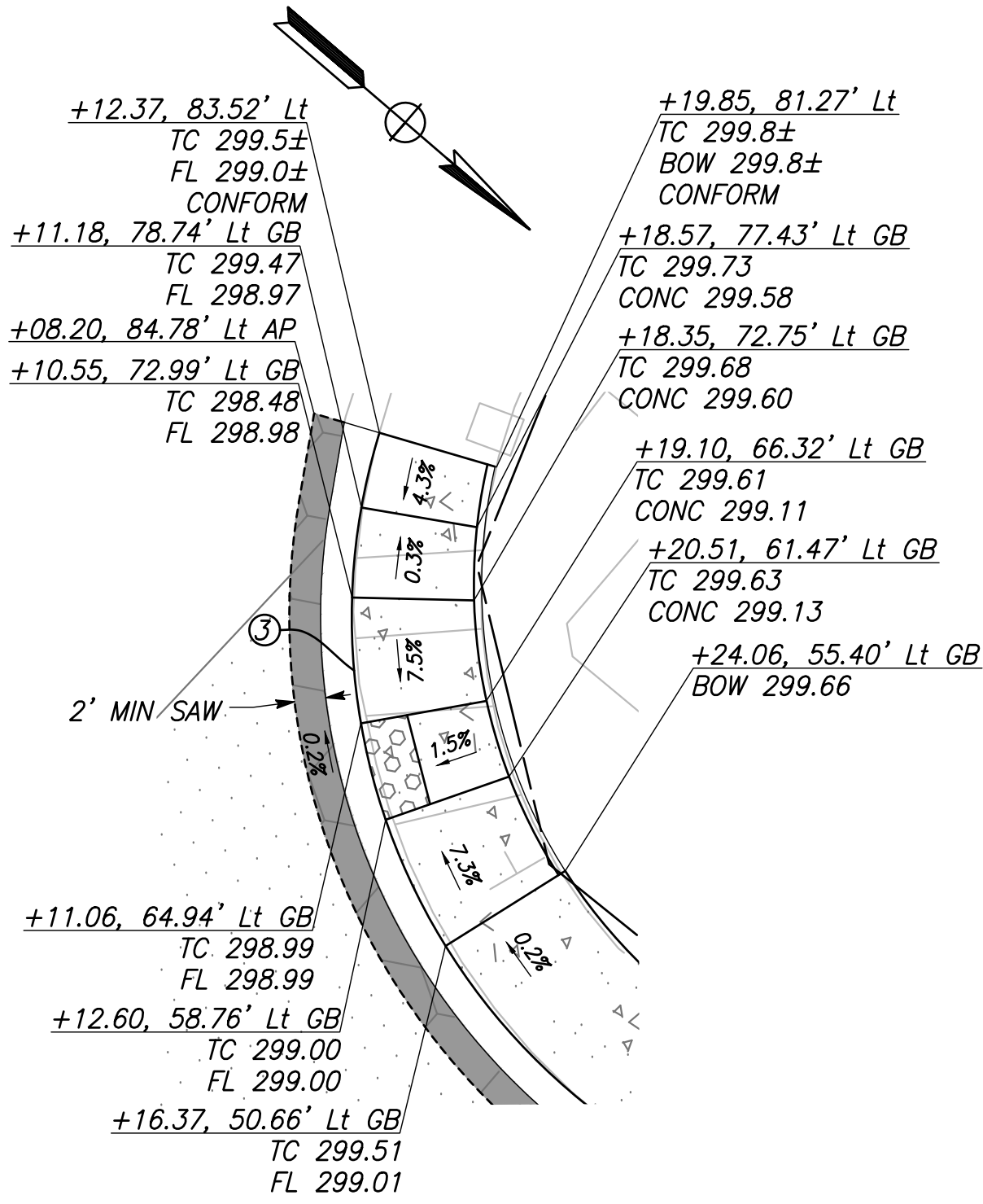

DESIGNED:	DATE	RECORD DRAWING	
CYNTHIA HORNER		RESIDENT ENGINEER	DATE
ERIK CHIN			
EDGAR NORIEGA			

FOR RIGHT OF WAY DATA AND ACCURATE ACCESS DETERMINATION, SEE DOCUMENTS IN THE DEPARTMENT OF PUBLIC WORKS AND PLANNING.



SUPERVISING ENGINEER DATE

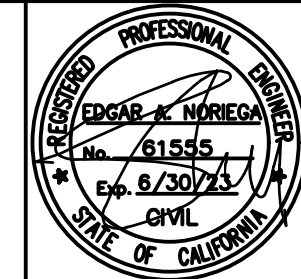

PROJECT - PHASE 1

GOLDEN STATE CORRIDOR - ECONOMIC DEVELOPMENT AND INFRASTRUCTURE IMPROVEMENTS

KINGSBURG REGION

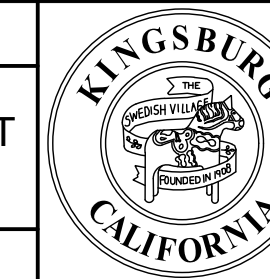

DEPARTMENT OF PUBLIC WORKS AND PLANNING

CONSTRUCTION DETAILS

DRAWING NO. CD-5 SHEET NO. 36A TOTAL 108

**NOTES**  
 1. ALL STATION AND OFFSET CALLOUTS ON THIS SHEET ARE IN REFERENCE TO THE "GSB-CL1" LINE UNLESS OTHERWISE NOTED

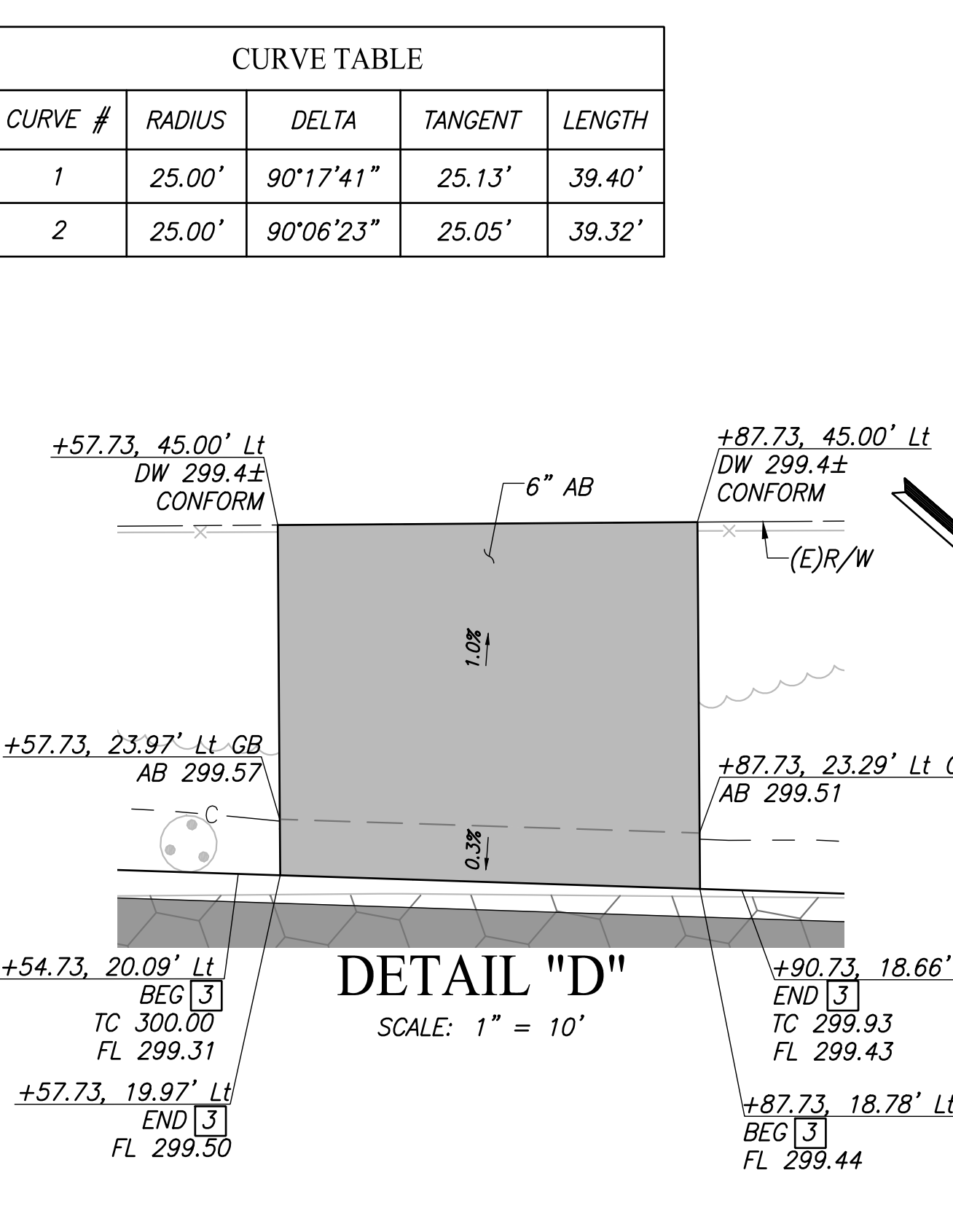
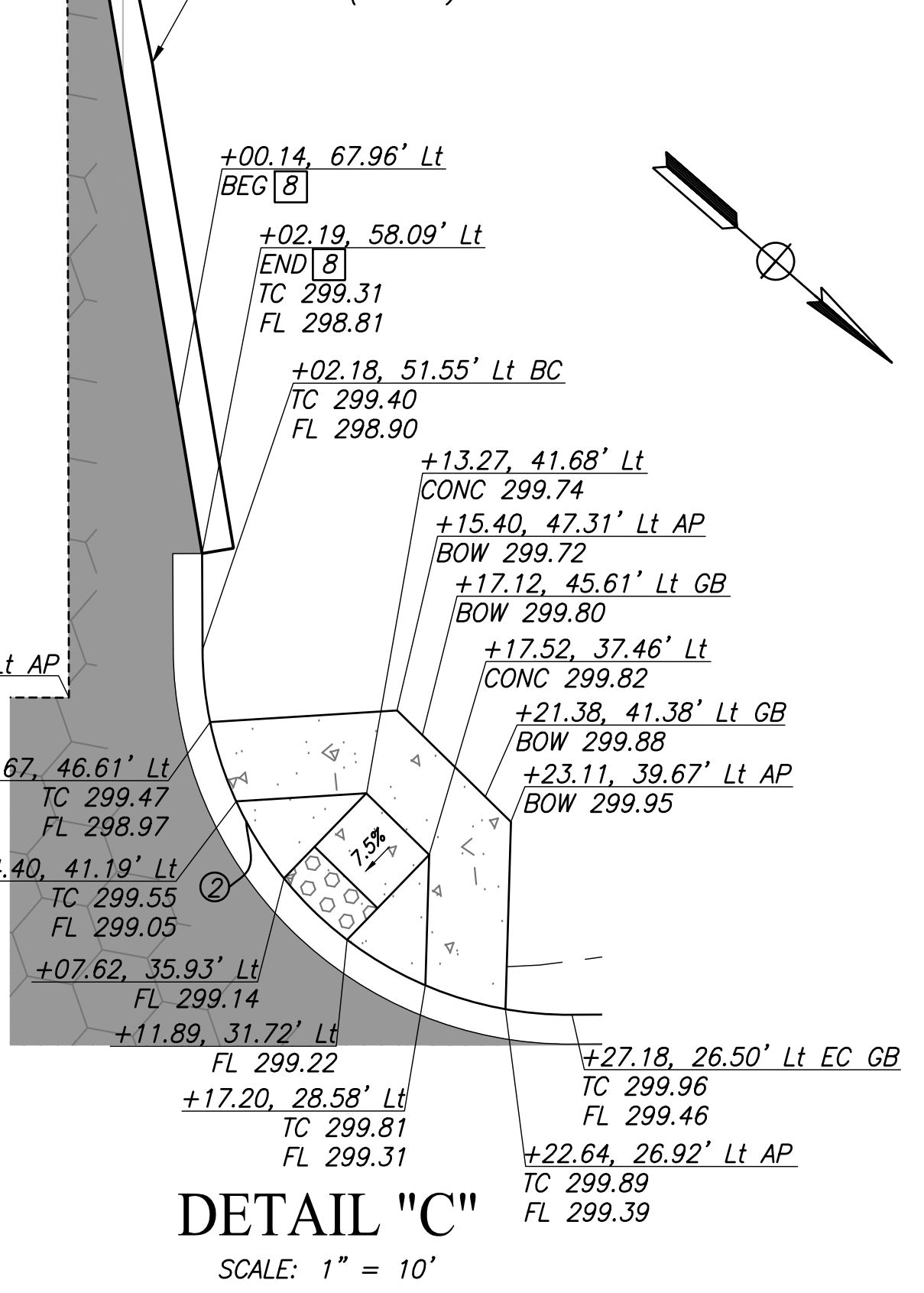
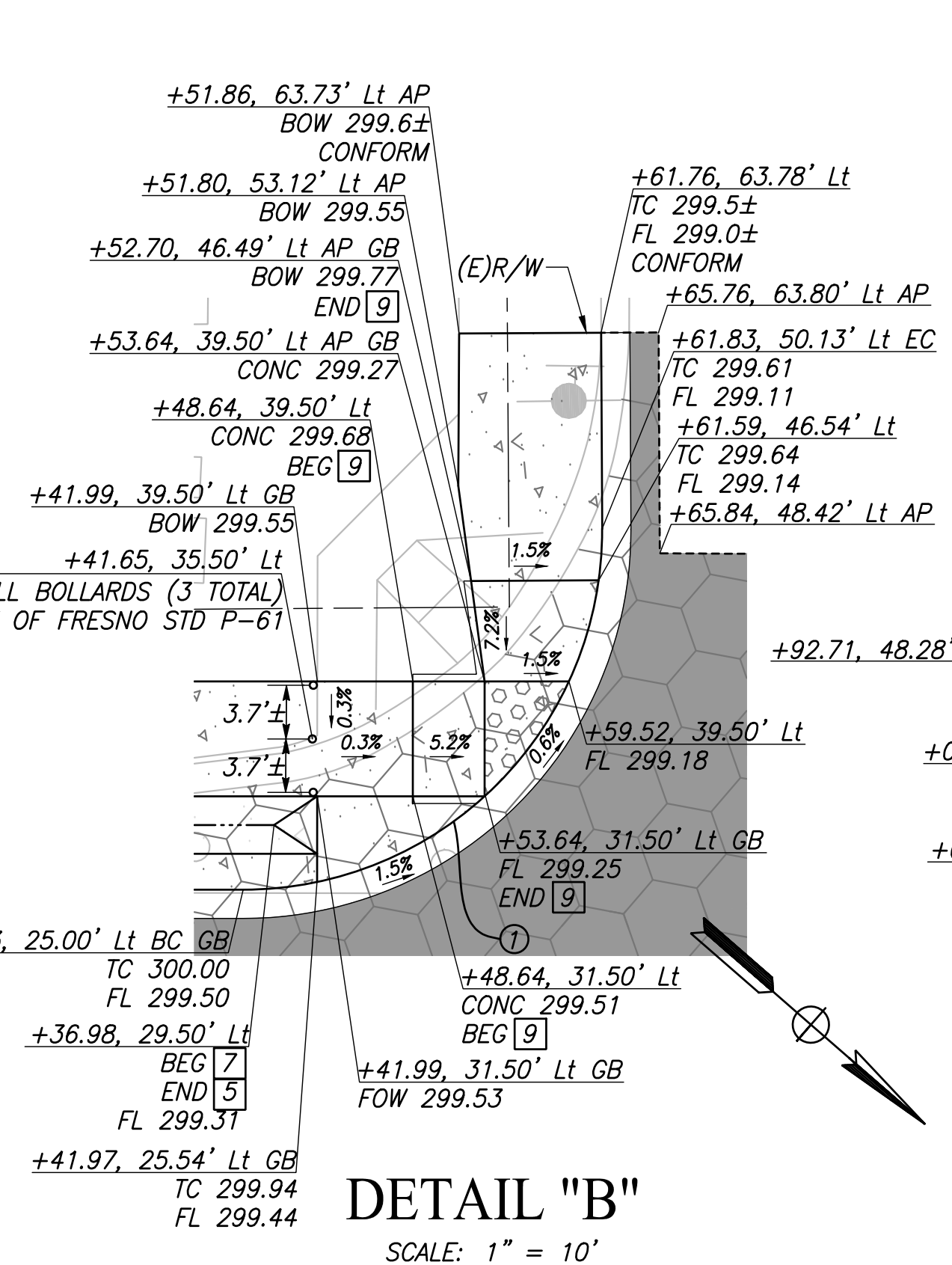
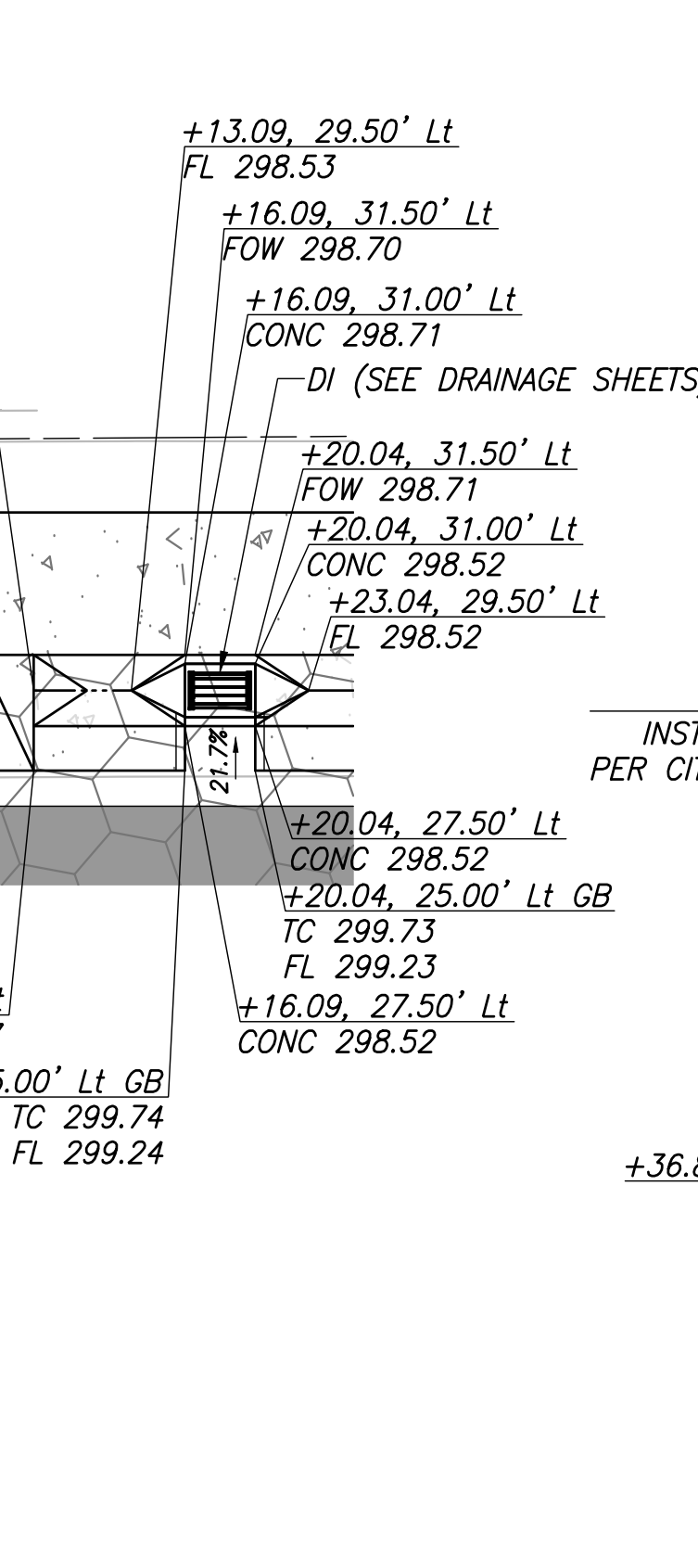
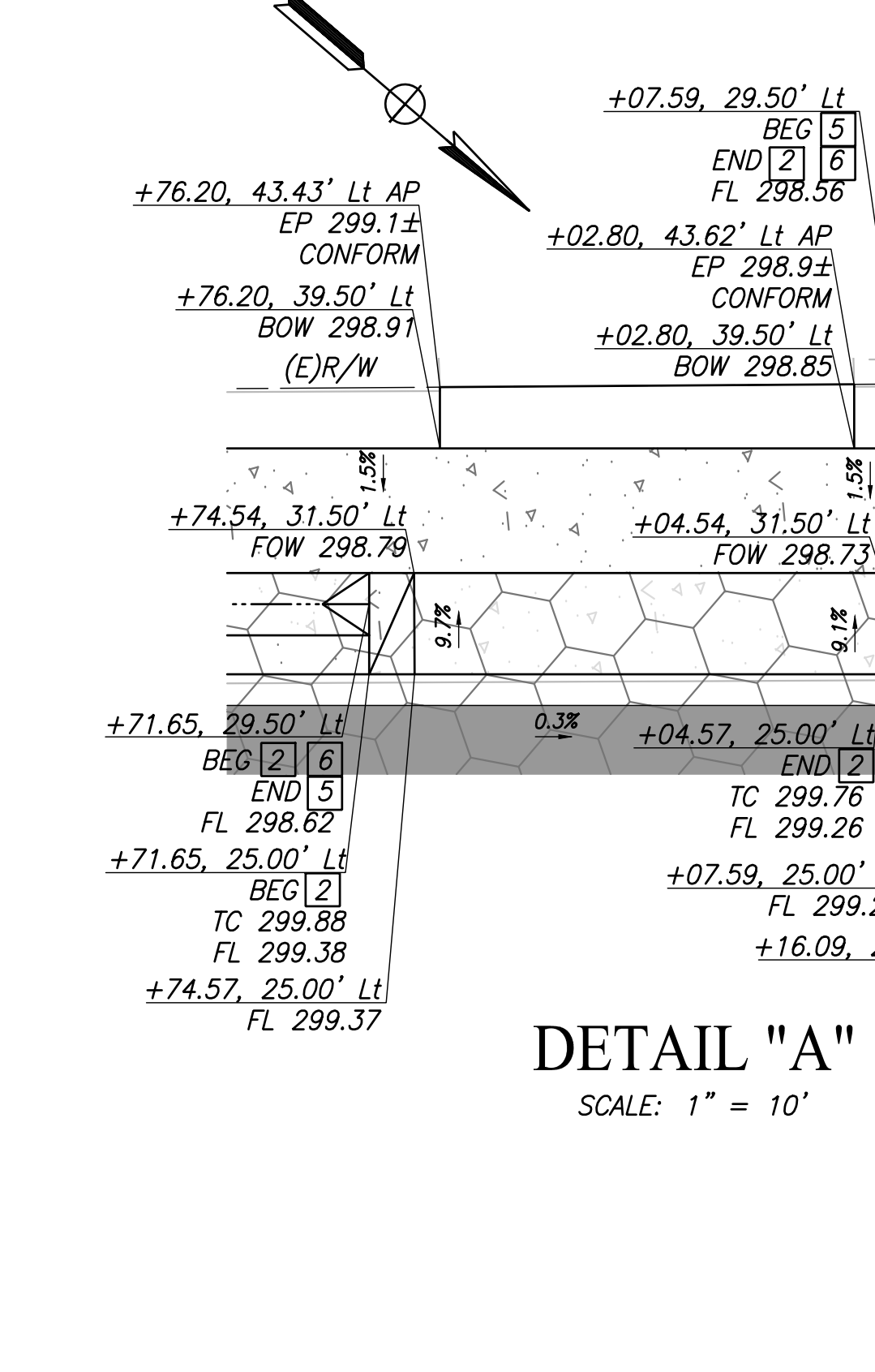
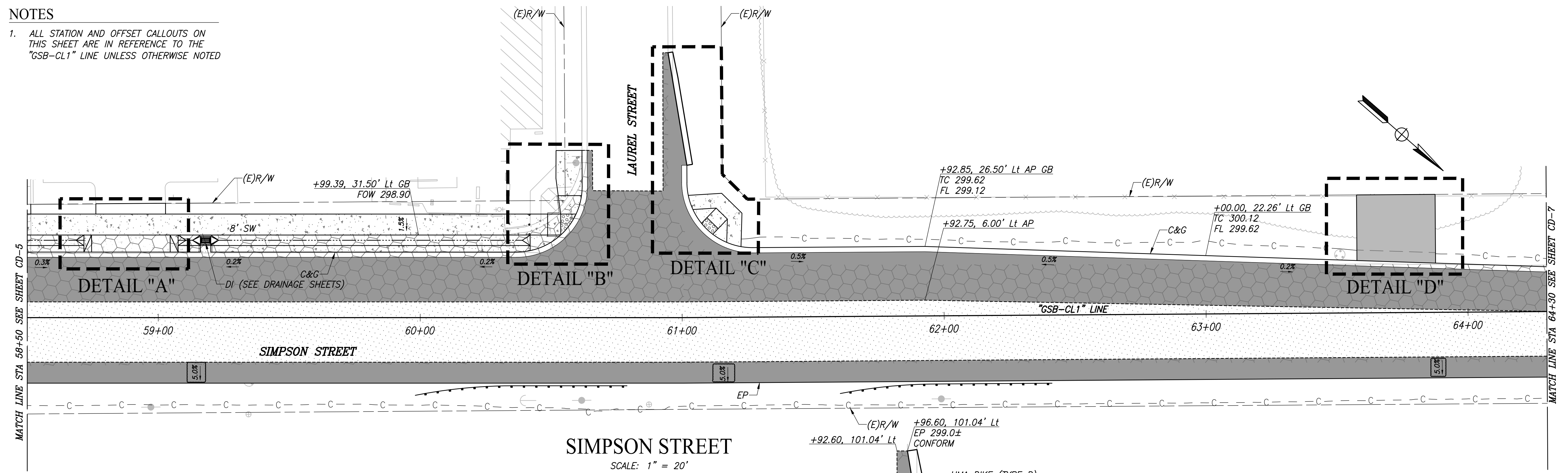

CURVE TABLE				
CURVE #	RADIUS	DELTA	TANGENT	LENGTH
1	25.00'	90°17'41"	25.13'	39.40'
2	25.00'	90°06'23"	25.05'	39.32'







PLOT DATE: 8/16/2022 9:40:37 AM  
 MATCH LINE STA 58+50 SEE SHEET CD-5  
 MATCH LINE STA 64+30 SEE SHEET CD-7  
 KINGSBURG REGION - PHASE 1 GSB - CL1 - CD1 - PLAN

DESIGNED: CYNTHIA HORNER DRAWN: ERIK CHIN CHECKED: EDGAR NORIEGA	DATE: _____ RESIDENT ENGINEER: _____ DATE: _____	<b>811</b> CALL BEFORE YOU DIG	 <b>MARK THOMAS</b> SUPERVISING ENGINEER	 <b>ERIK CHIN</b> CIVIL ENGINEER	<b>PROJECT - PHASE 1</b> GOLDEN STATE CORRIDOR - ECONOMIC DEVELOPMENT AND INFRASTRUCTURE IMPROVEMENTS KINGSBURG REGION	 <b>DEPARTMENT OF PUBLIC WORKS AND PLANNING</b> <b>CONSTRUCTION DETAILS</b> DRAWING NO. CD-6 SHEET NO. 37A TOTAL 108
--	--	-----------------------------------	--	--	---	---

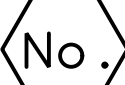

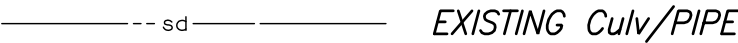
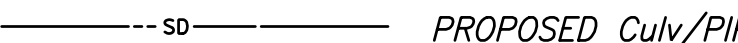
CAD USER: ECHIN  
 PLOT DATE: 09/16/2023 9:55:58 AM  
 P:\1\4\1\Fresno COG-PH-16105-GSB Final Design\CADD\Sheets\Region 1\GSB\_R1\_D-1-D-1.dwg

**LEGEND**

-  DRAINAGE SYSTEM NUMBER
-  DRAINAGE UNIT
-  DITCH FLOW LINE OR SWALE
-  EXISTING CULV/PIPE
-  PROPOSED CULV/PIPE
-  PROPOSED DI
-  EARTH BERM
-  RSP

**ABBREVIATIONS**

- BOT BOTTOM
- CULV CULVERT
- DI DRAINAGE INLET
- GB GRADE BREAK
- MH MAINHOLE
- OF OUTFALL
- RCP REINFORCED CONCRETE PIPE
- SD STORM DRAIN
- RSP ROCK SLOPE PROTECTION

**NOTES**

1. RIGHT-OF-WAY INFORMATION IS AVAILABLE AT THE CITY OF KINGSBURG OFFICE.
2. EXISTING DRAINAGE LOCATIONS ARE APPROXIMATE. CONTRACTOR SHALL VERIFY LOCATION AND ELEVATIONS BEFORE MODIFYING EXISTING DRAINAGE FACILITIES.
3. SEE DRAINAGE DETAILS (DD-1) FOR EARTH BERM DETAILS
4. EXISTING UG UTILITY LOCATIONS ARE APPROXIMATE EXACT DEPTH AND LOCATIONS UNKNOWN, FIELD LOCATE PRIOR TO START OF CONSTRUCTION.

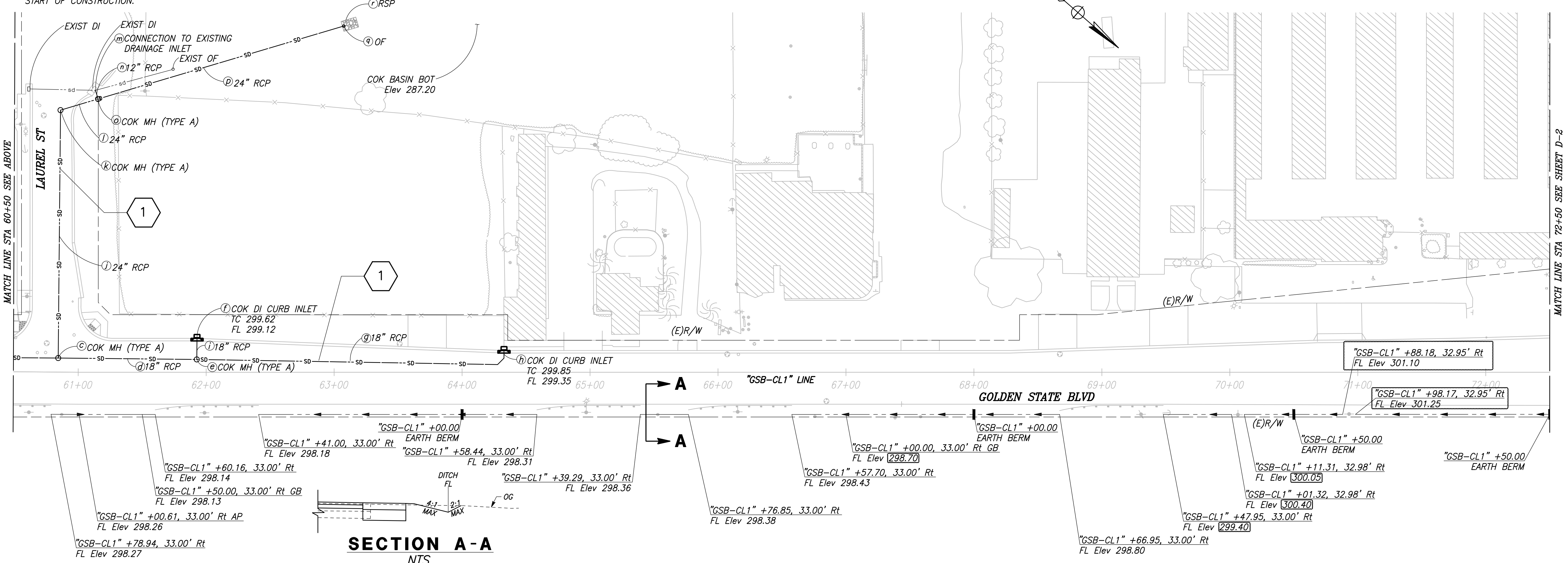
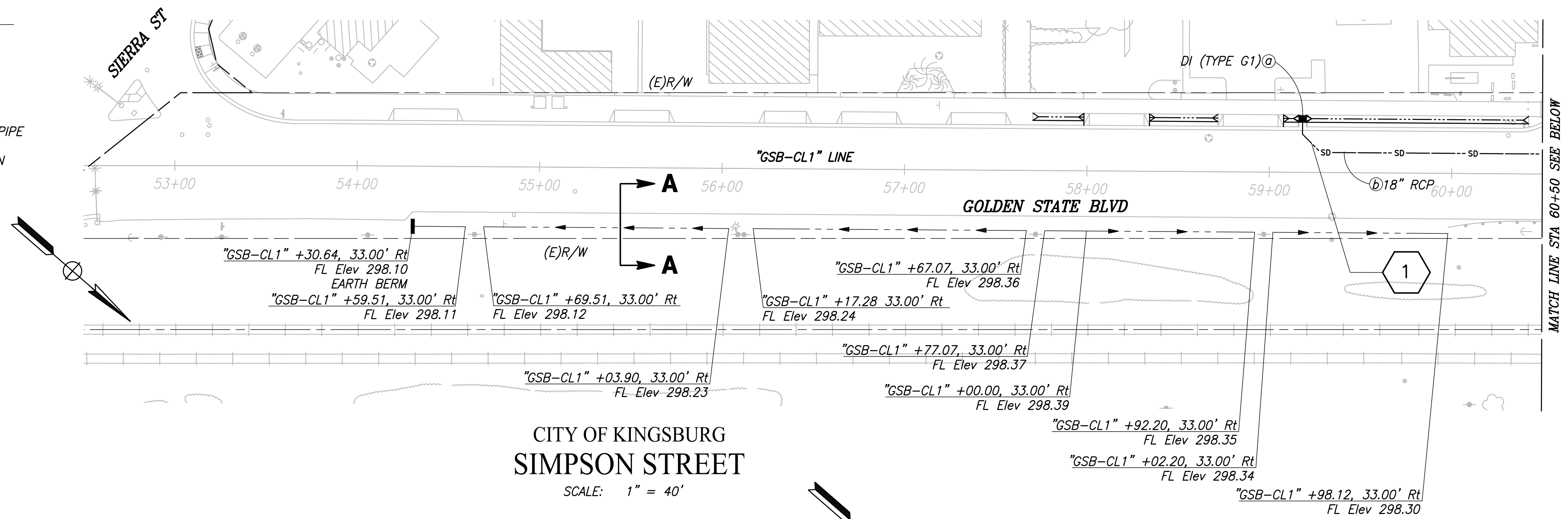

	DATE	RECORD DRAWING	
DESIGNED: CYNTHIA HORNER		RESIDENT ENGINEER	DATE
DRAWN: ERIK CHIN			
CHECKED: EDGAR NORIEGA			

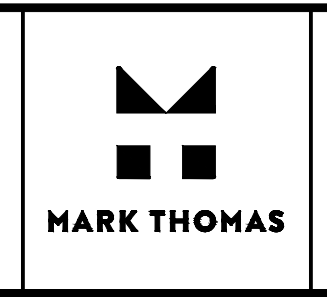

SUPERVISING ENGINEER	DATE
----------------------	------

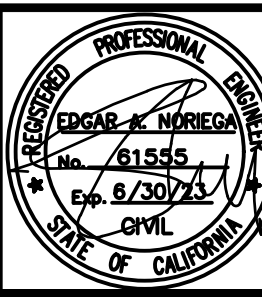

**PROJECT - PHASE 1**  
 GOLDEN STATE CORRIDOR - ECONOMIC DEVELOPMENT  
 AND INFRASTRUCTURE IMPROVEMENTS  
 KINGSBURG REGION



**DEPARTMENT OF PUBLIC WORKS AND PLANNING**  
**DRAINAGE PLAN**  
 DRAWING NO. D-1      SHEET NO. 53A      TOTAL 108

CAD USER, ECHIN

PLOT DATE: 8/16/2022 9:55:46 AM

PATH:\freaso\COG-PH-16105-GSB-Final Design\CADD\Sheets\Region 1-Kingsburg\Phase 1\GSB\_RT\_D1+04\_P1.dwg

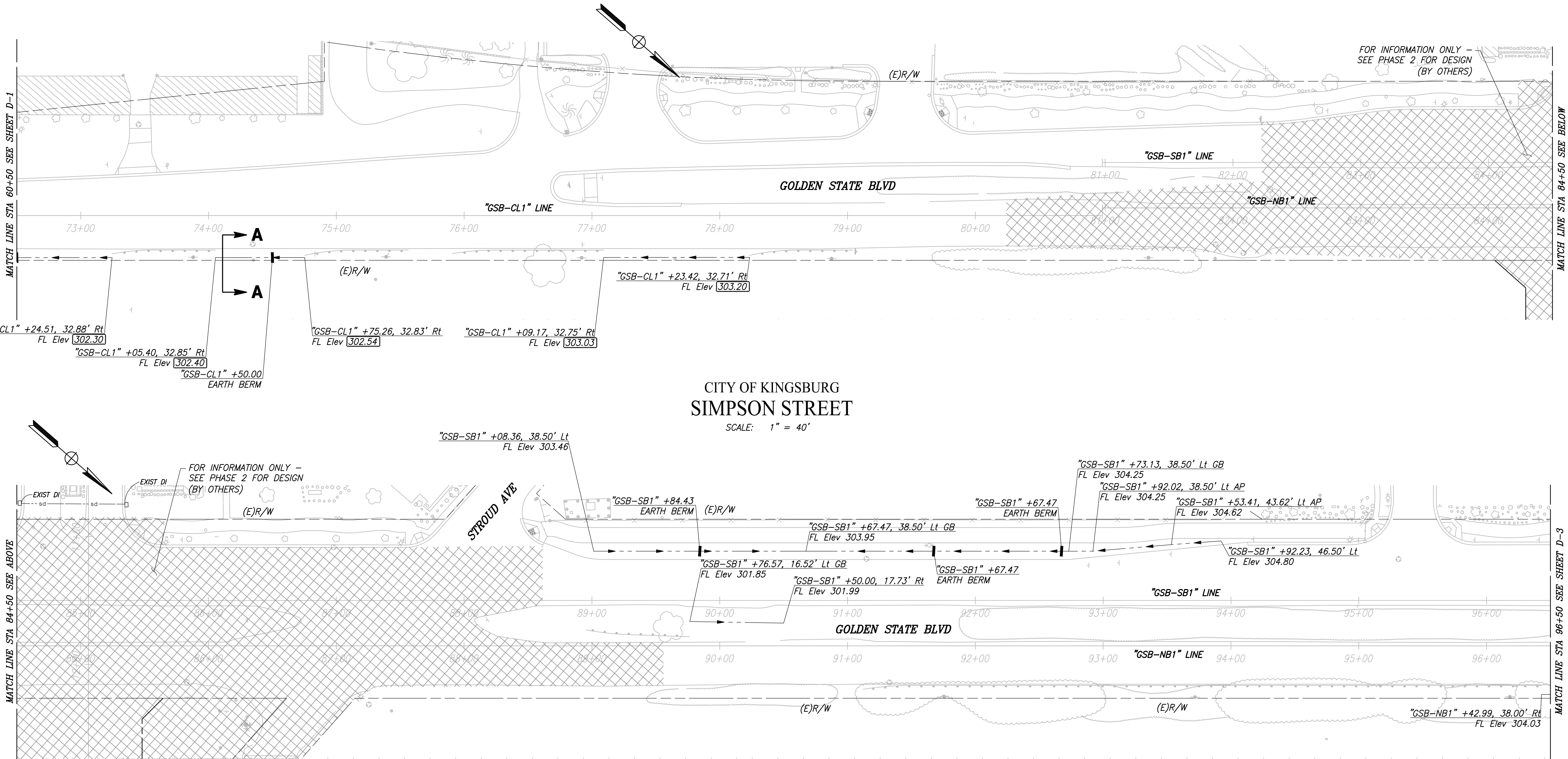

CITY OF KINGSBURG  
 SIMPSON STREET  
 SCALE: 1" = 40'

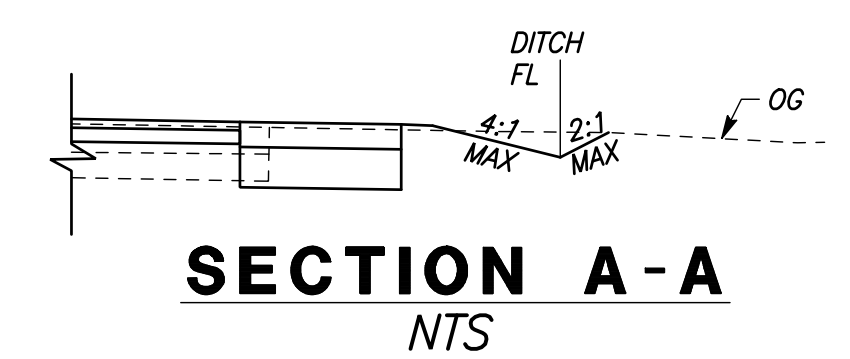

DESIGNED: CYNTHIA HORNER	DATE	RECORD DRAWING	
DRAWN: ERIK CHIN		RESIDENT ENGINEER	DATE
CHECKED: EDGAR NORIEGA			
FOR RIGHT OF WAY DATA AND ACCURATE ACCESS DETERMINATION, SEE DOCUMENTS IN THE DEPARTMENT OF PUBLIC WORKS AND PLANNING.			

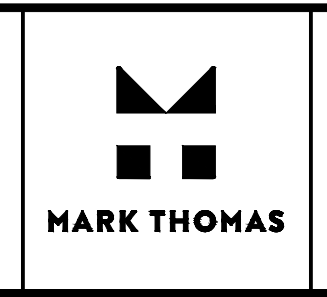

SUPERVISING ENGINEER	DATE
----------------------	------

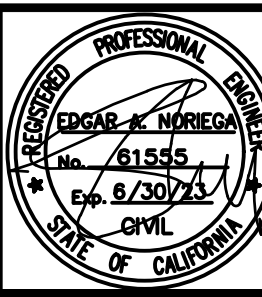

PROJECT - PHASE 1
GOLDEN STATE CORRIDOR - ECONOMIC DEVELOPMENT AND INFRASTRUCTURE IMPROVEMENTS
KINGSBURG REGION



DEPARTMENT OF PUBLIC WORKS AND PLANNING		
DRAINAGE PLAN		
DRAWING NO. D-2	SHEET NO. 54A	TOTAL 108



PLOT DATE: 09/16/2023 9:57:07 AM

CAD USER: ECHIN

PATH: I:\p000\16105-GSB Final Design\CADD\Sheets\Region 1\GSB\_RL\_D5-D7\_Plans

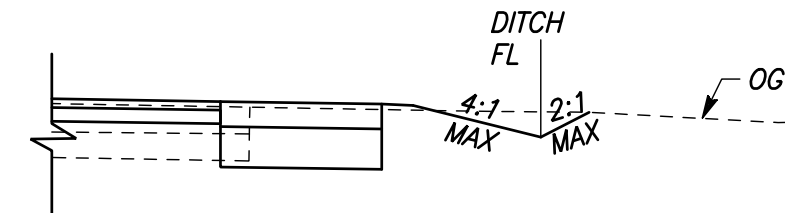
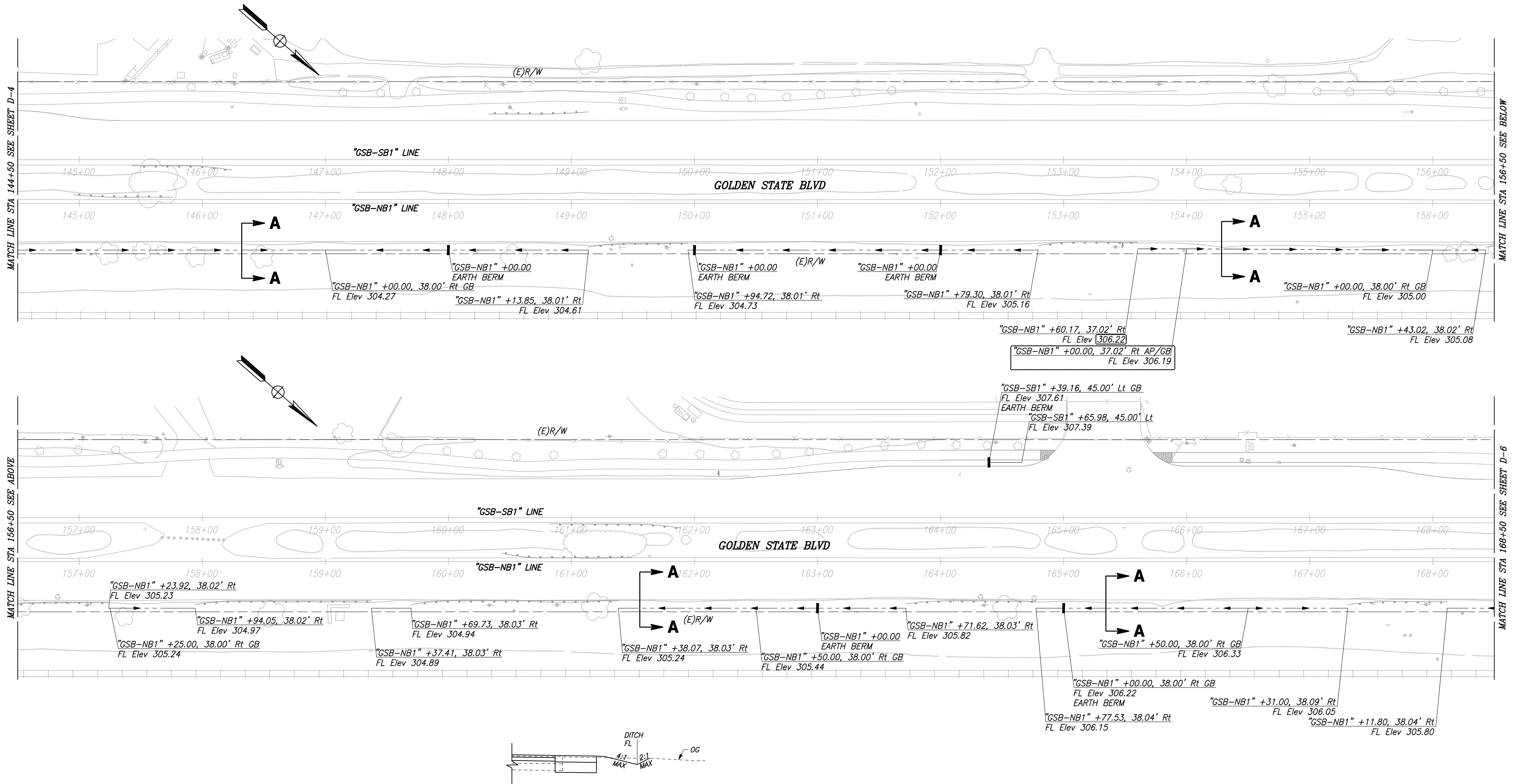

**SECTION A-A**  
NTS

DESIGNED: CYNTHIA HORNER	DATE	RECORD DRAWING	
DRAWN: ERIK CHIN		RESIDENT ENGINEER	DATE
CHECKED: EDGAR NORIEGA			
FOR RIGHT OF WAY DATA AND ACCURATE ACCESS DETERMINATION, SEE DOCUMENTS IN THE DEPARTMENT OF PUBLIC WORKS AND PLANNING.			

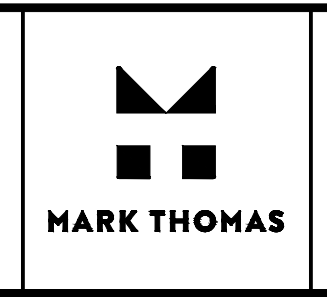

\_\_\_\_\_  
SUPERVISING ENGINEER

\_\_\_\_\_  
DATE

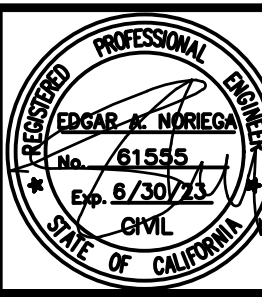

PROJECT - PHASE 1

GOLDEN STATE CORRIDOR - ECONOMIC DEVELOPMENT AND INFRASTRUCTURE IMPROVEMENTS

KINGSBURG REGION



DEPARTMENT OF PUBLIC WORKS AND PLANNING

**DRAINAGE PLAN**

DRAWING NO. D-5 SHEET NO. 57A TOTAL 108